



Schlüter®-KERDI-FIX

Schlüter®-KERDI-FIX is a MS polymer based elastic adhesive. It is suited for adjoining and sealing the abutments and joint areas of Schlüter®-KERDI waterproofing membrane sections.

(Product data sheet 8.3)



Schlüter®-KERDI-FIX		
MS polymer adhesive		
cartridge = 290 ml Art.-No.	€ / U.	P = Unit
KERDIFIX / BW	17.89	12
KERDIFIX / G	17.89	12

Schlüter®-KERDI-FIX		
MS polymer adhesive		
cartridge = 100 ml Art.-No.	€ / U.	P = Unit
KERDIFIX 100 G	10.87	16

Schlüter®-KERDI-LINE: Elegant drainage

Linear drainages bring elegance and functionality to floor-level showers. Schlüter®-KERDI-LINE is a complete system that includes all components for draining floor-level shower areas. My Schlüter®-KERDI-LINE adds a personal touch: Customers can choose to add an individual engraving to the grate and/or frame of the drainage channel.

- ✓ Up to 14 channel lengths.
- ✓ Low assembly heights.
- ✓ Complete sets with waterproofing collar.
- ✓ Four different channel covers.
- ✓ Stainless steel grates and frames individually customisable.
- ✓ Flexibly adjustable to tile thicknesses.
- ✓ Extensive assortment, including tapered profiles and splashguard profiles.



Schlüter®-KERDI-LINE-H

Schlüter®-KERDI-LINE-H is a complete set for linear floor level showers with a horizontal drain. It can be universally used for intermediate installation in floor or at wall areas. The perimeter of the channel body consists of an adhesive flange that is coated with a collar made of Schlüter®-KERDI. It ensures the reliable connection of the channel body to the bonded waterproofing assembly, both in the floor area and on upright walls.

(Product data sheet 8.7)

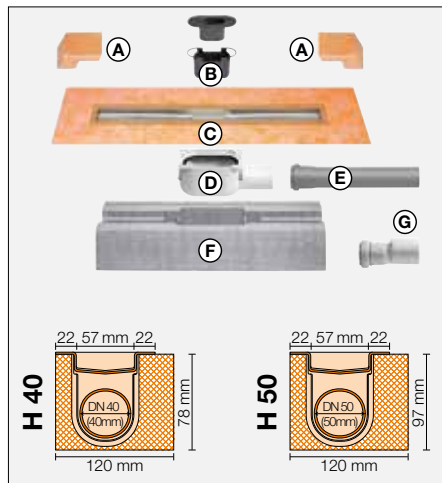
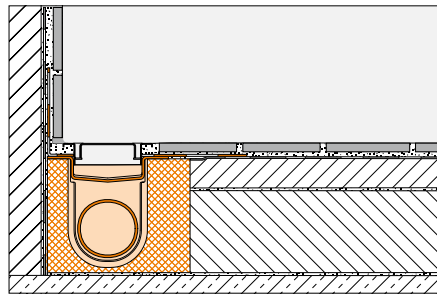

Set components:

- A Corner seal
(for lateral wall connection)
- B Two part odour trap
- C Channel body with waterproofing collar
- D Drain body
- E Drain pipe
- F Channel support
- G 40 mm adaptor
(only for KERDI-LINE-H 40)

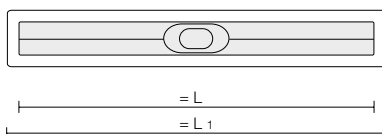

Technical data:

Drain: DN 40 / DN 50
 Drain capacity: 0.5 l/s/ 0.6 l/s
 Assembly height: 78 mm / 97 mm
 Width of cover including frame: 74 mm
 Lengths: 50 to 180 cm in increments of 10 cm

Schlüter®-KERDI-LINE-H 40

stainless steel V4A linear drainage set with odour trap, horizontal DN 40 drain

L = cm	L1 = cm	Art.-No.	€ / U.	P = Unit
50	55	KLH 40 GE 50	219.22	10
60	65	KLH 40 GE 60	228.10	10
70	75	KLH 40 GE 70	236.98	10
80	85	KLH 40 GE 80	245.84	10
90	95	KLH 40 GE 90	255.30	10
100	105	KLH 40 GE 100	264.72	10
110	115	KLH 40 GE 110	271.94	10
120	125	KLH 40 GE 120	280.27	10
130	135	KLH 40 GE 130	371.22	10
140	145	KLH 40 GE 140	381.03	10
150	155	KLH 40 GE 150	392.44	10
160	165	KLH 40 GE 160	406.49	10
170	175	KLH 40 GE 170	418.95	10
180	185	KLH 40 GE 180	433.27	10

Schlüter®-KERDI-LINE-H 50

stainless steel V4A linear drainage set with odour trap, horizontal DN 50 drain

L = cm	L1 = cm	Art.-No.	€ / U.	P = Unit
50	55	KLH 50 GE 50	219.22	10
60	65	KLH 50 GE 60	228.10	10
70	75	KLH 50 GE 70	236.98	10
80	85	KLH 50 GE 80	245.84	10
90	95	KLH 50 GE 90	255.30	10
100	105	KLH 50 GE 100	264.72	10
110	115	KLH 50 GE 110	271.94	10
120	125	KLH 50 GE 120	280.27	10
130	135	KLH 50 GE 130	371.22	10
140	145	KLH 50 GE 140	381.03	10
150	155	KLH 50 GE 150	392.44	10
160	165	KLH 50 GE 160	406.49	10
170	175	KLH 50 GE 170	418.95	10
180	185	KLH 50 GE 180	433.27	10

Note: Please see pages 104–106 for matching grate and frame combinations or covering supports.



Schlüter®-KERDI-LINE-F

Schlüter®-KERDI-LINE-F is a complete set for linear, floor level showers with horizontal drain. It can be universally used for intermediate installation in floor or wall areas and is particularly well suited for restoration and modernisation projects because its low assembly height of just 60 mm. A collar made of Schlüter®-KERDI is pre-adhered to the adhesive flange of the channel body for reliable connection to the bonded waterproofing assembly.

(Product data sheet 8.7)

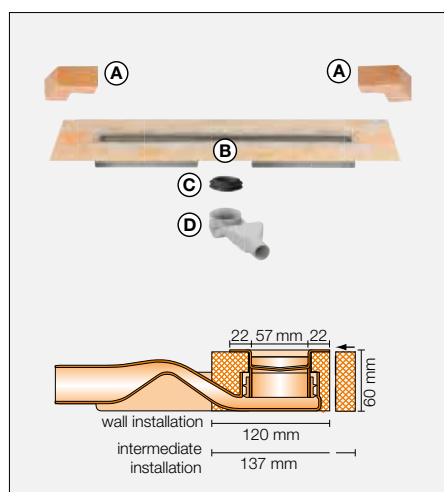
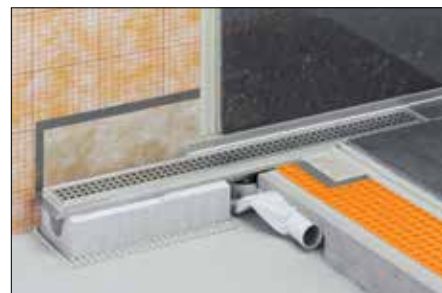
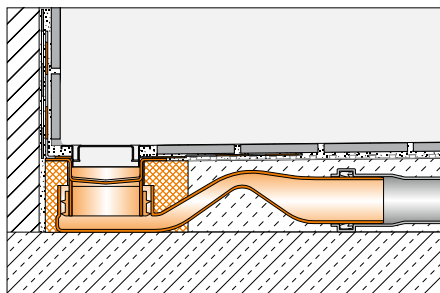

Set components:

- A Corner seal
(for lateral wall connection)
- B Channel body with waterproofing collar and channel support
- C Lip seal
- D Drain body with odour trap

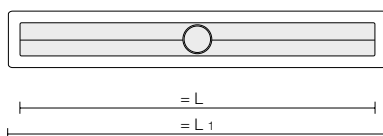

Schlüter®-KERDI-LINE-F 40

stainless steel V4A linear drainage set with integrated odour trap, horizontal DN 40 drain

L = cm	L1 = cm	Art.-No.	€ / U.	P = Unit
50	55	KLF 40 GE 50	219.22	10
60	65	KLF 40 GE 60	228.10	10
70	75	KLF 40 GE 70	236.98	10
80	85	KLF 40 GE 80	245.84	10
90	95	KLF 40 GE 90	255.30	10
100	105	KLF 40 GE 100	264.72	10
110	115	KLF 40 GE 110	271.94	10
120	125	KLF 40 GE 120	280.27	10



Schlüter®-KERDI collar, level for intermediate installation

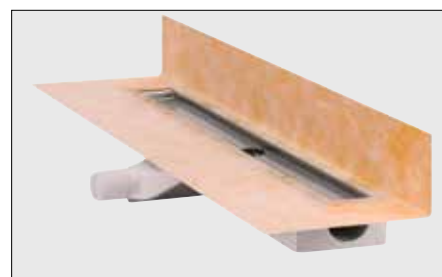

Schlüter®-KERDI collar, upright for wall installation

Note: Please see pages 104–106 for matching grate and frame combinations or covering supports.



Technical data:

Drain: DN 40
 Drain capacity: 0.45 l/s
 Assembly height: 60 mm
 Width of cover including frame: 74 mm
 Lengths: 50 to 120 cm in increments of 10 cm

Schlüter®-KERDI-LINE-V

Schlüter®-KERDI-LINE-V is a complete set for linear floor level showers with a vertical drain. It can be universally used for intermediate installation in floor or at wall areas. The perimeter of the channel body consists of an adhesive flange that is coated with a collar made of Schlüter®-KERDI. It ensures the reliable connection of the channel body to the bonded waterproofing assembly, both in the floor area and on upright walls.

(Product data sheet 8.7)

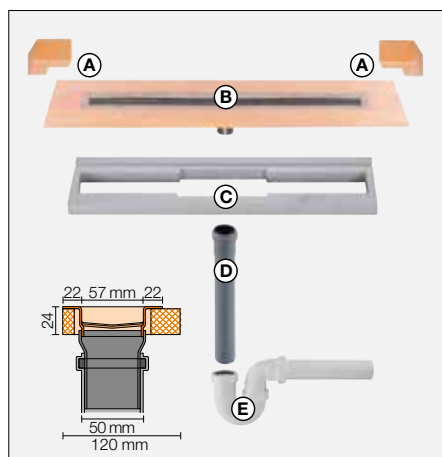
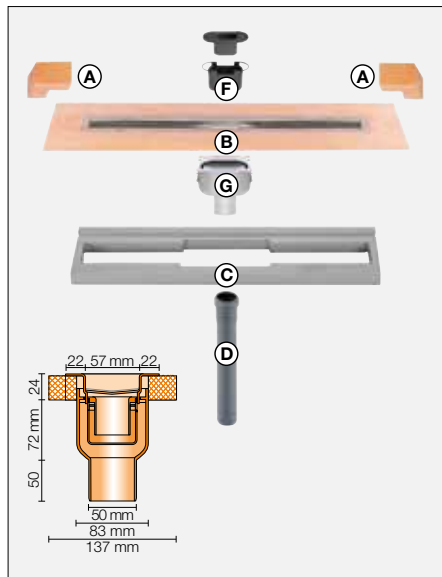
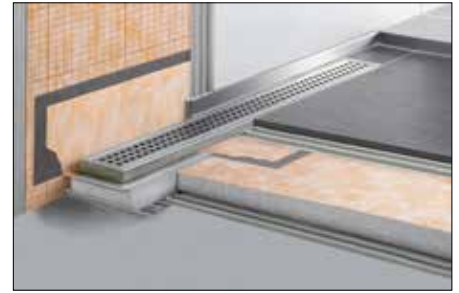
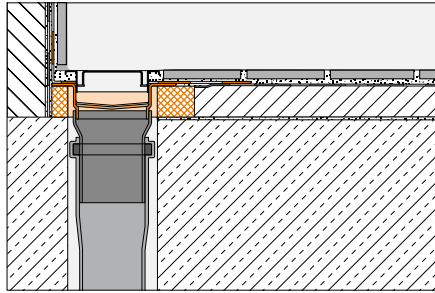

Set components:

- A Corner seal
(for lateral wall connection)
- B Channel body with waterproofing collar
- C Channel support
- D Drain pipe DN 50 (l = 250 mm)
- E Trap section
- F Two part odour trap
- G Drain body

Schlüter®-KERDI-LINE-V

stainless steel V4A linear drainage set with odour trap, vertical DN 50 drain

L = cm	L1 = cm	Art.-No.	€ / U.	P = Unit
50	55	KLV 50 GE 50	219.22	10
60	65	KLV 50 GE 60	228.10	10
70	75	KLV 50 GE 70	236.98	10
80	85	KLV 50 GE 80	245.84	10
90	95	KLV 50 GE 90	255.30	10
100	105	KLV 50 GE 100	264.72	10
110	115	KLV 50 GE 110	271.94	10
120	125	KLV 50 GE 120	280.27	10
130	135	KLV 50 GE 130	371.22	10
140	145	KLV 50 GE 140	381.03	10
150	155	KLV 50 GE 150	392.44	10
160	165	KLV 50 GE 160	406.49	10
170	175	KLV 50 GE 170	418.95	10
180	185	KLV 50 GE 180	433.27	10

Schlüter®-KERDI-LINE-VS

stainless steel V4A linear drainage set without odour trap, vertical DN 50 drain

L = cm	L1 = cm	Art.-No.	€ / U.	P = Unit
50	55	KLV 50 GSE 50	219.22	10
60	65	KLV 50 GSE 60	228.10	10
70	75	KLV 50 GSE 70	236.98	10
80	85	KLV 50 GSE 80	245.84	10
90	95	KLV 50 GSE 90	255.30	10
100	105	KLV 50 GSE 100	264.72	10
110	115	KLV 50 GSE 110	271.94	10
120	125	KLV 50 GSE 120	280.27	10
130	135	KLV 50 GSE 130	371.22	10
140	145	KLV 50 GSE 140	381.03	10
150	155	KLV 50 GSE 150	392.44	10
160	165	KLV 50 GSE 160	406.49	10
170	175	KLV 50 GSE 170	418.95	10
180	185	KLV 50 GSE 180	433.27	10

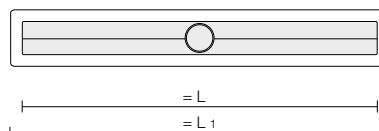

Note: Please see pages 104–106 for matching grate and frame combinations or covering supports.

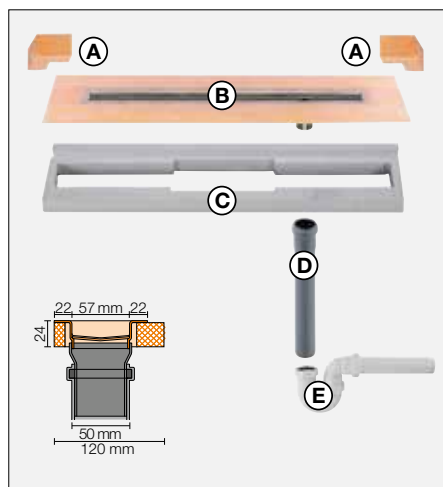
**Set components:**

- A Corner seal
(for lateral wall connection)
- B Channel body with waterproofing collar
- C Channel support
- D Drain pipe DN 50 (l = 250 mm)
- E Trap section

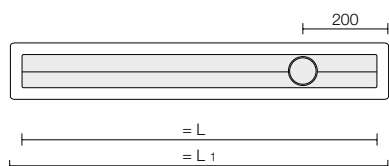
**Schlüter®-KERDI-LINE-VOS**

stainless steel linear drainage set V4A without odour trap,
off-centre drainage, vertical drain DN 50

L = cm	L1 = cm	Art.-No.	€/ U.	P = Unit
70	75	KLVO 50 GSE 70	281.33	10
80	85	KLVO 50 GSE 80	290.09	10
90	95	KLVO 50 GSE 90	302.28	10
100	105	KLVO 50 GSE 100	313.15	10
110	115	KLVO 50 GSE 110	319.78	10
120	125	KLVO 50 GSE 120	328.80	10



Schlüter®-KERDI collar, level for intermediate installation

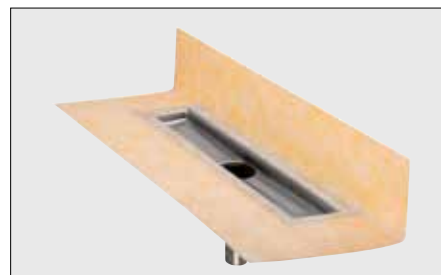

Schlüter®-KERDI collar, upright for wall installation

Note:

Please see pages 104–105 for matching grate and frame combinations.

i

Technical data:

Drain: DN 50
 Drain capacity: 1.0 l/s (VS/VOS), 0.8 l/s (V)
 Assembly height: 24 mm
 Width of cover grate including frame: 74 mm
 Lengths: 50 to 180 cm in increments of 10 cm (V/VS)
 Lengths: 70 to 120 cm in increments of 10 cm (VOS)



Schlüter®-KERDI-LINE-A/-B/-C

Schlüter®-KERDI-LINE are insertion frames of brushed stainless steel with designer grate covers that match the Schlüter®-KERDI-LINE channel bodies. The insertion frame is seamlessly height adjustable to accommodate covering materials in thicknesses from 3 to 25 mm. Designer grate A, B and C are available as design options.

(Product data sheet 8.7)

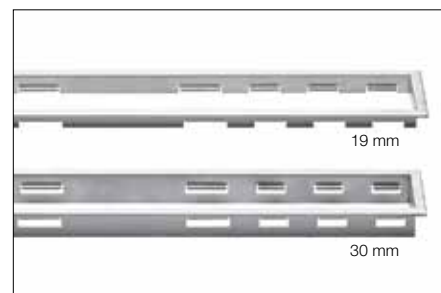
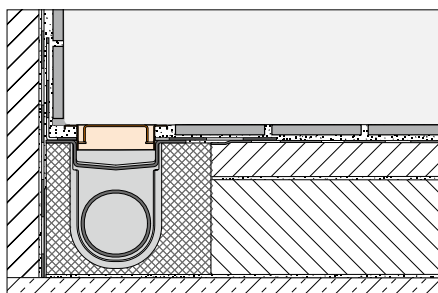

Schlüter®-KERDI-LINE-A

design grate A with 19 mm frame,
stainless steel V4A, brushed

L = cm	H = 19 mm Art.-No.	€/ U.	P = Unit
50	KLA 19 EB 50	179.26	10
60	KLA 19 EB 60	184.04	10
70	KLA 19 EB 70	188.69	10
80	KLA 19 EB 80	193.46	10
90	KLA 19 EB 90	198.13	10
100	KLA 19 EB 100	202.79	10
110	KLA 19 EB 110	207.77	10
120	KLA 19 EB 120	212.56	10
130	KLA 19 EB 130	302.54	10
140	KLA 19 EB 140	316.33	10
150	KLA 19 EB 150	327.21	10
160	KLA 19 EB 160	344.70	10
170	KLA 19 EB 170	359.02	10
180	KLA 19 EB 180	371.22	10

Schlüter®-KERDI-LINE-B

design grate B with 19 mm frame,
stainless steel V4A, brushed

L = cm	H = 19 mm Art.-No.	€/ U.	P = Unit
50	KLB 19 EB 50	179.26	10
60	KLB 19 EB 60	184.04	10
70	KLB 19 EB 70	188.69	10
80	KLB 19 EB 80	193.46	10
90	KLB 19 EB 90	198.13	10
100	KLB 19 EB 100	202.79	10
110	KLB 19 EB 110	207.77	10
120	KLB 19 EB 120	212.56	10
130	KLB 19 EB 130	302.54	10
140	KLB 19 EB 140	316.33	10
150	KLB 19 EB 150	327.21	10
160	KLB 19 EB 160	344.70	10
170	KLB 19 EB 170	359.02	10
180	KLB 19 EB 180	371.22	10

Schlüter®-KERDI-LINE-C

tile pan C with 19 mm frame,
stainless steel V4A, brushed

L = cm	H = 19 mm Art.-No.	€/ U.	P = Unit
50	KLC 19 EB 50	179.26	10
60	KLC 19 EB 60	184.04	10
70	KLC 19 EB 70	188.69	10
80	KLC 19 EB 80	193.46	10
90	KLC 19 EB 90	198.13	10
100	KLC 19 EB 100	202.79	10
110	KLC 19 EB 110	207.77	10
120	KLC 19 EB 120	212.56	10
130	KLC 19 EB 130	302.54	10
140	KLC 19 EB 140	316.33	10
150	KLC 19 EB 150	327.21	10
160	KLC 19 EB 160	344.70	10
170	KLC 19 EB 170	359.02	10
180	KLC 19 EB 180	371.22	10

Schlüter®-KERDI-LINE-A

design grate A with 30 mm frame,
stainless steel V4A, brushed

L = cm	H = 30 mm Art.-No.	€/ U.	P = Unit
50	KLA 30 EB 50	184.82	10
60	KLA 30 EB 60	189.25	10
70	KLA 30 EB 70	194.02	10
80	KLA 30 EB 80	199.68	10
90	KLA 30 EB 90	203.68	10
100	KLA 30 EB 100	208.67	10
110	KLA 30 EB 110	213.55	10
120	KLA 30 EB 120	217.55	10

Schlüter®-KERDI-LINE-B

design grate B with 30 mm frame,
stainless steel V4A, brushed

L = cm	H = 30 mm Art.-No.	€/ U.	P = Unit
50	KLB 30 EB 50	184.82	10
60	KLB 30 EB 60	189.25	10
70	KLB 30 EB 70	194.02	10
80	KLB 30 EB 80	199.68	10
90	KLB 30 EB 90	203.68	10
100	KLB 30 EB 100	208.67	10
110	KLB 30 EB 110	213.55	10
120	KLB 30 EB 120	217.55	10

Schlüter®-KERDI-LINE-C

tile pan C with 30 mm frame,
stainless steel V4A, brushed

L = cm	H = 30 mm Art.-No.	€/ U.	P = Unit
50	KLC 30 EB 50	184.82	10
60	KLC 30 EB 60	189.25	10
70	KLC 30 EB 70	194.02	10
80	KLC 30 EB 80	199.68	10
90	KLC 30 EB 90	203.68	10
100	KLC 30 EB 100	208.67	10
110	KLC 30 EB 110	213.55	10
120	KLC 30 EB 120	217.55	10

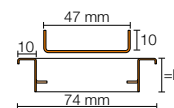
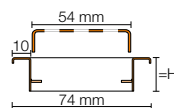
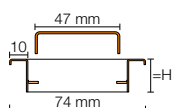

Note: H = 19 mm covering thicknesses 3 – 15 mm
H = 30 mm covering thicknesses 13 – 25 mm

Note: The designer grate for tile insert C is suitable for tile thicknesses up to 10 mm



My Schlüter®-KERDI-LINE: Creative. Individual. Unique.

A special personal touch for showers: With My KERDI-LINE, you can add personalised engravings to the grates and/or frames of our linear drains.

This page lists the engraving charges for the grate/frame combinations shown on the opposite page. Simply add the corresponding engraving letters to the article number in your order.

- ✓ For lengths up to 120 cm.
- ✓ Three different engraving types available.
- ✓ Precise, durable, high-quality.



Schlüter®-KERDI-LINE-A 19 mm

with deep engraving, grate only (G1)		with surface engraving, grate only (G2)		with crosshatch engraving, grate only (G3)	
Art.-No.	Surcharge € / U.	Art.-No.	Surcharge € / U.	Art.-No.	Surcharge € / U.
...* G1	45.00	...* G2	55.00	...* G3	30.00

with deep engraving on grate + crosshatch engraving on frame (G1R)		with surface engraving on grate + crosshatch engraving on frame (G2R)		with crosshatch engraving on grate and frame (G3R)	
Art.-No.	Surcharge € / U.	Art.-No.	Surcharge € / U.	Art.-No.	Surcharge € / U.
...* G1R	72.50	...* G2R	82.50	...* G3R	57.50

with crosshatch engraving, frame only (GR)	
Art.-No.	Surcharge € / U.
...* GR	27.50

Schlüter®-KERDI-LINE-B 19 mm

with crosshatch engraving, frame only (GR)	
Art.-No.	Surcharge € / U.
...* GR	27.50

Schlüter®-KERDI-LINE-C 19 mm

with crosshatch engraving, frame only (GR)	
Art.-No.	Surcharge € / U.
...* GR	27.50

* Add Art. No. (e.g. KLA 19 EB 70 G1R)



Deep engraving



Surface engraving



Crosshatch engraving

Schlüter®-KERDI-LINE-FC

Schlüter®-KERDI-LINE-FC is a stainless steel insert for the optical appearance between drain frames and grates when positioned in serial alignment.

(Product data sheet 8.7)

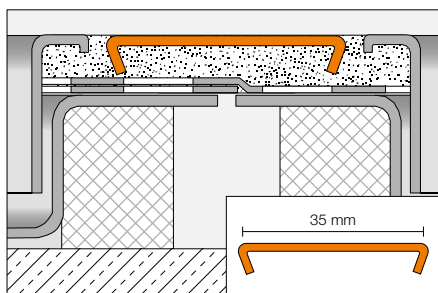

Schlüter®-KERDI-LINE-FC

frame connector,
brushed stainless steel V4A

Art.-No.	€/ U.	P = Unit
V / KLEB 35	10.53	10



Schlüter®-KERDI-LINE-D

Schlüter®-KERDI-LINE-D is a frameless channel cover to match Schlüter®-KERDI-LINE channel bodies. The covering support features a fleece fabric for bonding with the tile adhesive and is universally suitable for all covering thicknesses.

(Product data sheet 8.7)

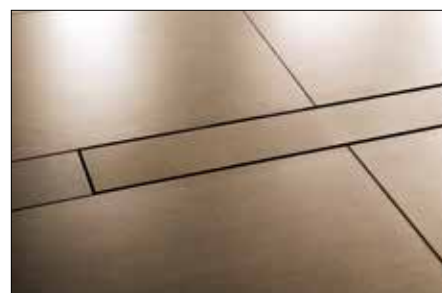
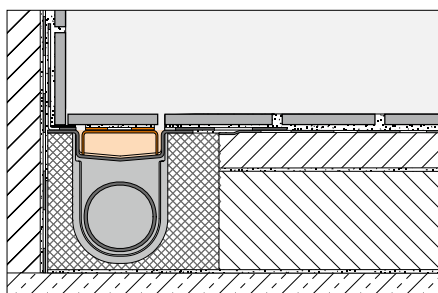

Schlüter®-KERDI-LINE-D

designer grate D frameless design,
stainless steel V4A

L = cm	Art.-No.	€/ U.	P = Unit
49	KLD E 50	73.81	10
59	KLD E 60	77.98	10
69	KLD E 70	83.53	10
79	KLD E 80	88.51	10
89	KLD E 90	93.24	10
99	KLD E 100	99.07	10
109	KLD E 110	104.88	10
119	KLD E 120	109.61	10
129	KLD E 130	161.54	10
139	KLD E 140	166.46	10
149	KLD E 150	173.73	10
159	KLD E 160	181.89	10
169	KLD E 170	188.95	10
179	KLD E 180	204.17	10

Note: The length of the selected covering support must match the channel length. Schlüter®-KERDI-LINE-D cannot be combined with the eccentric vertical drain Schlüter®-KERDI-LINE-VOS.

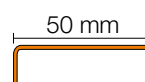

Schlüter®-KERDI-LINE-A sets

Schlüter®-KERDI-LINE-A sets are complete sets for linear floor-level showers with a horizontal drain. The linear drain set can be positioned centrally or at the perimeter of the shower area. A collar made of Schlüter®-KERDI is pre-adhered to the flange on the surround of the channel body, and ensures the reliable connection of the channel body to the bonded waterproofing assembly, both in the floor and in wall areas. The set also includes a brushed stainless steel design grate Schlüter®-KERDI-LINE-A to match the channel bodies.

(Product data sheet 8.7)

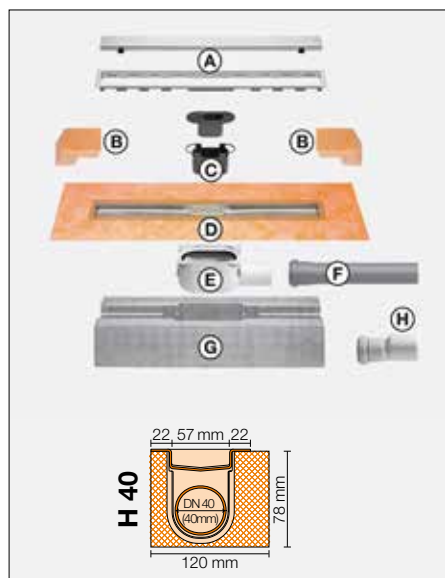

Set components:

- A Grate and frame combination with design grate A
- B Corner seal (for lateral wall connection)
- C Two part odour trap
- D Channel body with waterproofing collar
- E Drain body
- F Drain pipe
- G Channel support
- H 40 mm adaptor

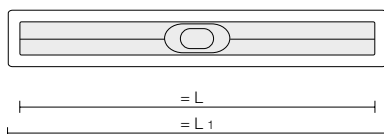

Schlüter®-KERDI-LINE-A set

stainless steel V4A linear drain with odour trap, horizontal DN 40 drain, incl. design grate A with 19 mm frame, brushed stainless steel V4A

L = cm	L1 = cm	Art.-No.	€ / Set	PL = Set
80	85	KLA 19 EB 80 S1	418.50	10
90	95	KLA 19 EB 90 S1	430.00	10

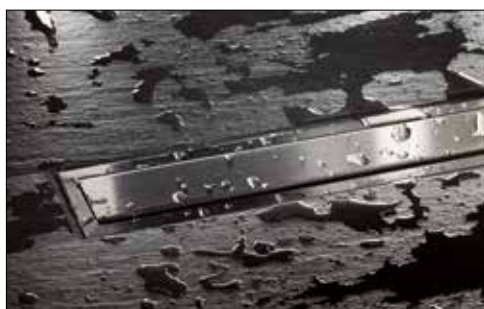

i

Technical data:

Drain: DN 40
 Drain capacity: 0.5 l/s
 Frame height 19 mm for tile thicknesses 3–15 mm
 Assembly height: 78 mm
 Width of cover including frame: 74 mm
 Lengths: 80/90 cm

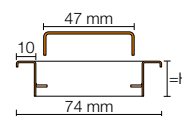

Schlüter®-KERDI-SHOWER-LCS

Schlüter®-KERDI-SHOWER-LCS is a set with a two part sloped tray with a 2% slope and a pre-adhered coating of Schlüter®-KERDI for the direct installation of tiles in floor level showers and for the connection of the folded parts of the sloped tray. It is attached to the previously installed linear drain Schlüter®-KERDI-LINE in the wall area, with a precise fit over the previously installed levelling board, included in the set.

(Product data sheet 8.8)

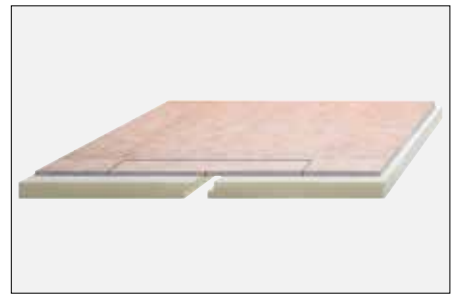
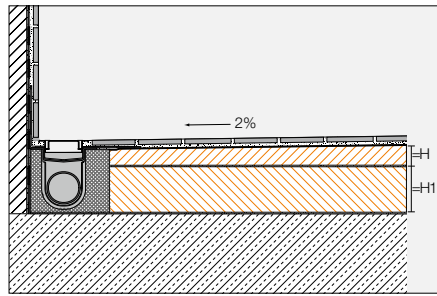

Schlüter®-KERDI-SHOWER-LCS

sloped tray and levelling board for Schlüter®-KERDI-LINE-H 40 for installation in wall transition areas

L x B = cm	H = mm	H1 = mm	Art.-No.	€ / Set	P = Set
100 x 100	42	51	KSLC B 1000 S	165.88	10
140 x 140	50	51	KSLC B 1400 S	273.62	10

Schlüter®-KERDI-SHOWER-LCS

sloped tray and levelling board for Schlüter®-KERDI-LINE-H 50 for installation in wall transition areas

L x B = cm	H = mm	H1 = mm	Art.-No.	€ / Set	P = Set
100 x 100	42	70	KSLC 1000 S	165.88	10
140 x 140	50	70	KSLC 1400 S	273.62	10

Note: Use Schlüter®-KERDI-KERS (see page 97) for secure waterproofing in the corner area.

A prefabricated fitting is included to cover drain pipes that protrude over the length of the channel.

Schlüter®-KERDI-SHOWER-LS

Schlüter®-KERDI-SHOWER-LS is a sloped tray with a 2% slope and a pre-adhered coating of Schlüter®-KERDI for the direct installation of tiles in floor level showers and for the connection of the folded parts of the sloped tray. It is attached to the previously installed linear drain Schlüter®-KERDI-LINE in the wall area, with a precise fit over the substructure supplied at the corresponding construction site.

(Product data sheet 8.8)

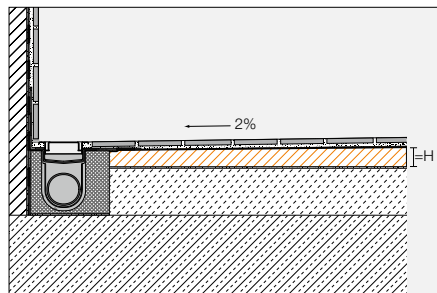

Schlüter®-KERDI-SHOWER-LS

sloped tray with Schlüter®-KERDI for installation in wall transition areas

L x B = cm	H = mm	Art.-No.	€ / U.	P = Unit
100 x 100	42	KSL 1000 S	117.60	10
140 x 140	50	KSL 1400 S	174.81	10

Note: Use Schlüter®-KERDI-KERS (see page 97) for secure waterproofing in the corner area.

Matches Schlüter®-KERDI-LINE-H and -KERDI-LINE-V – not suitable for Schlüter®-KERDI-LINE-F.



Schlüter®-KERDI-SHOWER-BSLS

Schlüter®-KERDI-SHOWER-BSLS is a sloped tray for floor level showers with a 2% slope. It is attached to the previously installed linear drain Schlüter®-KERDI-LINE in the wall area, with a precise fit over the substructure supplied at the corresponding construction site. It is suitable for the installation of heated or unheated screeds, and preferably Schlüter®-BEKOTEC screeds, in the shower area.

(Product data sheet 8.8)

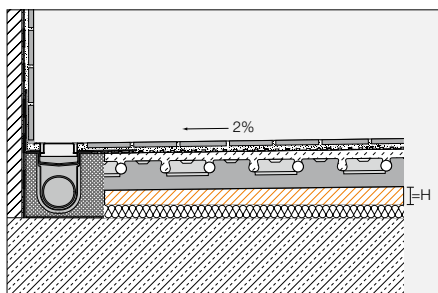

Schlüter®-KERDI-SHOWER-BSLS

sloped tray for installation below Schlüter®-BEKOTEC screeds
for installation in wall transition areas

L x B = cm	H = mm	Art.-No.	€ / U.	P = Unit
100 x 100	42	BSL 1000 S	61.05	10
140 x 140	50	BSL 1400 S	99.91	10

Note: Use Schlüter®-KERDI-KERS (see page 97) for secure waterproofing in the corner area.

Matches Schlüter®-KERDI-LINE-H and -KERDI-LINE-V – not suitable for Schlüter®-KERDI-LINE-F.

Schlüter®-KERDI-SHOWER-LC

Schlüter®-KERDI-SHOWER-LC is a set with a two part sloped tray with a 2% slope and a pre-adhered coating of Schlüter®-KERDI for the direct installation of tiles in floor level showers and for the connection of the folded parts of the sloped tray. It is attached to the previously installed linear drain Schlüter®-KERDI-LINE in the centre area, with a precise fit over the previously installed levelling board, included in the set.

(Product data sheet 8.8)

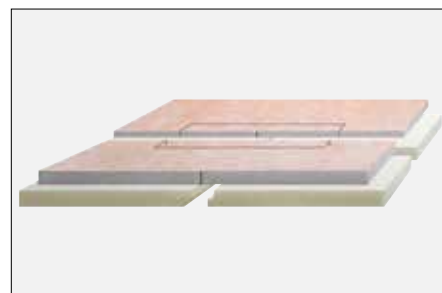
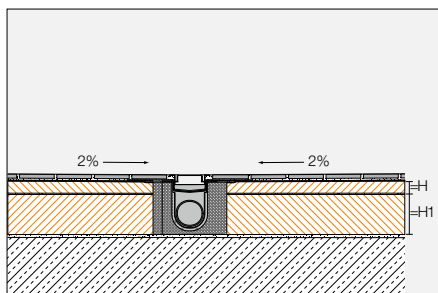

Schlüter®-KERDI-SHOWER-LC

two part sloped tray and levelling board for Schlüter®-KERDI-LINE-H 40,
for installation in the intermediate of tiled areas

L x B = cm	H = mm	H1 = mm	Art.-No.	€ / Set	P = Set
100 x 100	32	51	KSLC B 1000	165.88	10
140 x 140	36	51	KSLC B 1400	273.62	10

Schlüter®-KERDI-SHOWER-LC

two part sloped tray and levelling board for Schlüter®-KERDI-LINE-H 50,
for installation in the intermediate of tiled areas

L x B = cm	H = mm	H1 = mm	Art.-No.	€ / Set	P = Set
100 x 100	32	70	KSLC 1000	165.88	10
140 x 140	36	70	KSLC 1400	273.62	10

A prefabricated fitting is included to cover drain pipes that protrude over the length of the channel.

Schlüter®-KERDI-SHOWER-L

Schlüter®-KERDI-SHOWER-L is a two part sloped tray with a 2% slope and a pre-adhered coating of Schlüter®-KERDI for the direct installation of tiles in floor level showers and for the connection of the folded parts of the sloped tray. It is attached to the previously installed linear drain Schlüter®-KERDI-LINE in the intermediate area, with a precise fit over the substructure supplied at the corresponding construction site. (Product data sheet 8.8)

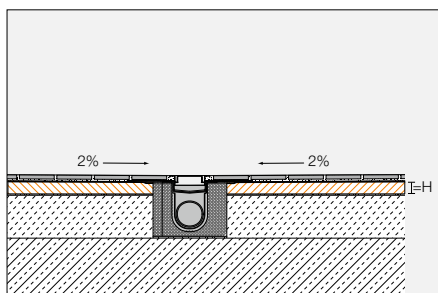

Schlüter®-KERDI-SHOWER-L

sloped tray with Schlüter®-KERDI for installation in the intermediate of tiled areas

L x B = cm	H = mm	Art.-No.	€ / U.	P = Unit
100 x 100	32	KSL 1000	117.60	10
140 x 140	36	KSL 1400	174.81	10

Matches Schlüter®-KERDI-LINE-H and -KERDI-LINE-V – not suitable for Schlüter®-KERDI-LINE-F.

Schlüter®-KERDI-SHOWER-BSL

Schlüter®-KERDI-SHOWER-BSL a sloped tray for floor level showers with a 2% slope. It is attached to the previously installed linear drain Schlüter®-KERDI-LINE in the intermediate area, with a precise fit over the substructure supplied at the corresponding construction site. It is suitable for the installation of heated or unheated screeds, and preferably Schlüter®-BEKOTEC screeds, in the shower area. (Product data sheet 8.8)

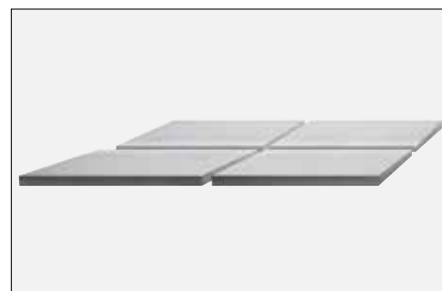
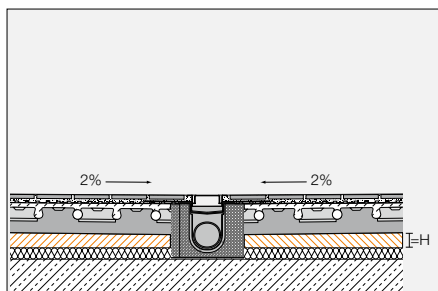

Schlüter®-KERDI-SHOWER-BSL

sloped tray for installation below Schlüter®-BEKOTEC screeds
for installation in the intermediate of tiled areas

L x B = cm	H = mm	Art.-No.	€ / U.	P = Unit
100 x 100	32	BSL 1000	61.05	10
140 x 140	36	BSL 1400	99.91	10

Matches Schlüter®-KERDI-LINE-H and -KERDI-LINE-V – not suitable for Schlüter®-KERDI-LINE-F.



Schlüter®-SHOWERPROFILE-S

Schlüter®-SHOWERPROFILE-S is a triangular profile made of a brushed stainless steel flat profile with 2% slope for covering the sloped edges of floor level showers. A fleece fabric is laminated on the reverse of the profile for bonding with the tile adhesive. A matching hard PVC support profile is available in different heights and features a U shaped installation channel. The triangular profile can be shortened as necessary on the short and/or long side to accommodate height adjustment. The triangular profile can be used on the left or right side of the floor transition or below the tiles of a lateral wall.

(Product data sheet 14.1)

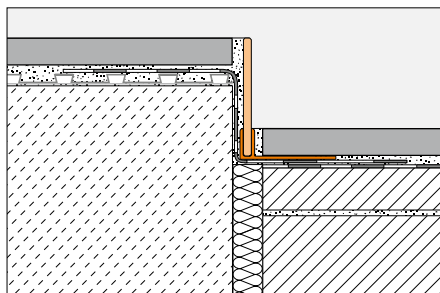

Schlüter®-SHOWERPROFILE-SPS 50			
PVC tapered support profile, brushed stainless steel V4A, H1= 6 mm			
H = mm	L = 1.20 m Art.-No.	€/ U.	KV = Unit
5	SPSA 50 EB/120	41.73	40
	L = 1.60 m		
5	SPSA 50 EB/160	57.22	40
	L = 2.00 m		
5	SPSA 50 EB/200	82.08	40

Schlüter®-SHOWERPROFILE-SPS 100			
PVC tapered support profile, brushed stainless steel V4A, H1= 10 mm			
H = mm	L = 1.20 m Art.-No.	€/ U.	KV = Unit
10	SPSB 100 EB/120	44.73	40
	L = 1.60 m		
10	SPSB 100 EB/160	58.60	40
	L = 2.00 m		
10	SPSB 100 EB/200	87.08	40

Schlüter®-SHOWERPROFILE-SPS 125			
PVC tapered support profile, brushed stainless steel V4A, H1= 10 mm			
H = mm	L = 1.20 m Art.-No.	€/ U.	KV = Unit
12.5	SPSB 125 EB/120	44.73	40
	L = 1.60 m		
12.5	SPSB 125 EB/160	58.60	40
	L = 2.00 m		
12.5	SPSB 125 EB/200	87.08	40

SPS 50

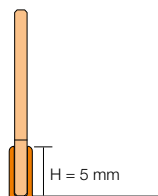

H = height of support profile
SPS 50 is suitable for tile thicknesses of 6–9 mm

SPS 100

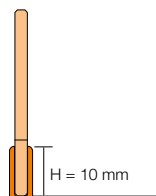

H = height of support profile
SPS 100 is suitable for tile thicknesses of 10–18 mm

SPS 125

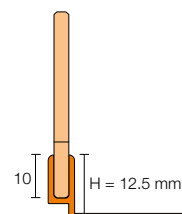

H = height of support profile
SPS 125 is suitable for tile thicknesses from 12.5 to 20 mm

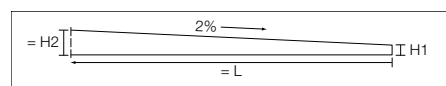

Triangular profile 120 cm: H2 = 30 mm, H1 = 6 mm
Triangular profile 160 cm: H2 = 38 mm, H1 = 6 mm
Triangular profile 200 cm: H2 = 46 mm, H1 = 6 mm

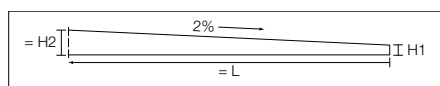

Triangular profile 120 cm: H2 = 34 mm, H1 = 10 mm
Triangular profile 160 cm: H2 = 42 mm, H1 = 10 mm
Triangular profile 200 cm: H2 = 50 mm, H1 = 10 mm

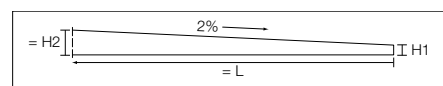

Triangular profile 120 cm: H2 = 34 mm, H1 = 10 mm
Triangular profile 160 cm: H2 = 42 mm, H1 = 10 mm
Triangular profile 200 cm: H2 = 50 mm, H1 = 10 mm

2 % = 2 mm / 10 cm

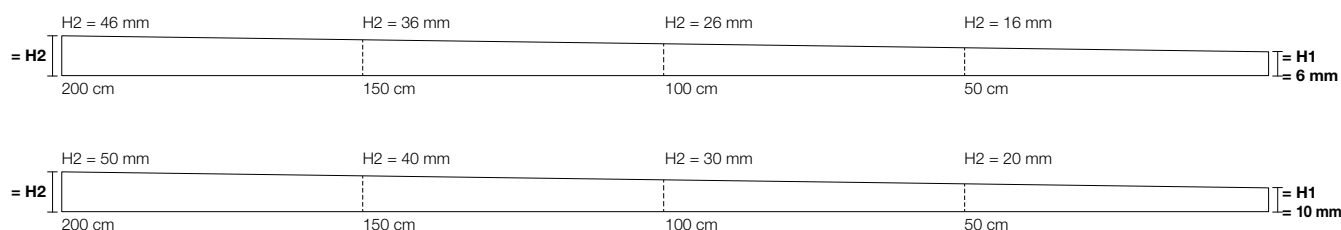

Note: Tapered profiles with higher support profiles in the heights 15, 18 and 22 mm are available upon request for greater tile thicknesses.

Schlüter®-SHOWERPROFILE-R

Schlüter®-SHOWERPROFILE-R is a two part wall transition profile for covering the wall area exposed due to the use of a wedge with a line drainage channel. The visible surface of the profile consists of brushed stainless steel. A fleece fabric is laminated the reverse for bonding with the tile adhesive. Due to the two part design, Schlüter®-SHOWERPROFILE-R can be seamlessly adjusted to any height between 23 and 45 mm (available in two versions).

(Product data sheet 14.1)

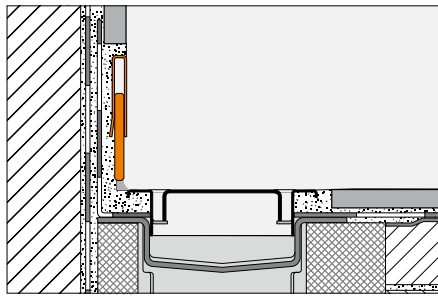

Schlüter®-SHOWERPROFILE-RA

two part wall transition profile,
brushed stainless steel V4A

H = mm	L = 1.00 m Art.-No.	€ / U.	KV = Unit
23-35	SPRA 23 EB/100	46.56	40
33-45	SPRA 33 EB/100	51.00	40
L = 1.40 m			
23-35	SPRA 23 EB/140	57.66	40
33-45	SPRA 33 EB/140	63.22	40

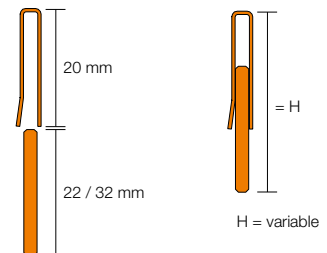

Schlüter®-SHOWERPROFILE-WS

Schlüter®-SHOWERPROFILE-WS is a two piece profile of anodised aluminium that serves as a splashguard in floor level showers. The support profile is embedded in the tile adhesive during tile installation. It can be fitted with a semi-circular or upright straight lip to protect against splashing. Both variations are suitable for wheelchair use.

(Product data sheet 14.2)

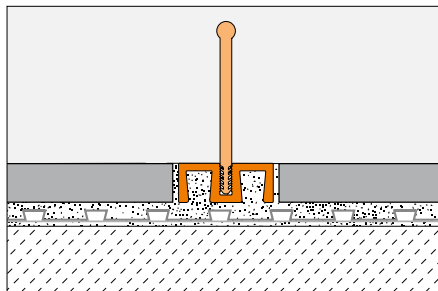

Schlüter®-SHOWERPROFILE-WS

support profile anodised aluminium,
natural satin

L = 1.00 m Art.-No.	€ / m	P = Unit
SPWS 19 AE / 100	19.32	40
L = 2.50 m		
SPWS 19 AE	18.54	40
L = 3.00 m		
SPWS 19 AE / 300	18.54	40

Schlüter®-SHOWERPROFILE-WSC

semi-circular lip

L = 1.00 m Art.-No.	€ / m	P = Unit
SPWSC 16 GS / 100	9.55	40
L = 2.50 m		
SPWSC 16 GS	9.55	40
L = 3.00 m		
SPWSC 16 GS / 300	9.55	40

Schlüter®-SHOWERPROFILE-WSL

straight lip

L = 1.00 m Art.-No.	€ / m	P = Unit
SPWSL 30 T / 100	11.53	40
L = 2.50 m		
SPWSL 30 T	11.53	40
L = 3.00 m		
SPWSL 30 T / 300	11.53	40

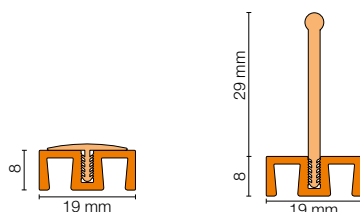

SHOWERPROFILE-WS + -WSC SHOWERPROFILE-WS + -WSL





Schlüter®-SHOWERPROFILE-WSK

Schlüter®-SHOWERPROFILE-WSK is a two piece profile of anodised aluminium that serves as a splashguard in floor level showers. The support profile is adhered to existing coverings. It can be fitted with a semi-circular or upright straight lip to protect against splashing. Both variations are suitable for wheelchair use.

(Product data sheet 14.2)

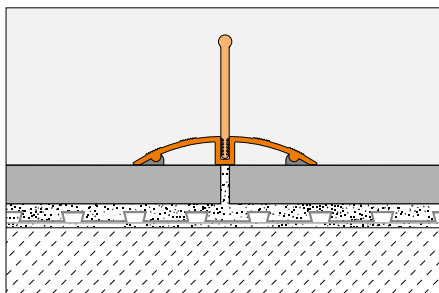

Schlüter®-SHOWERPROFILE-WSK

support profile anodised aluminium, natural satin

L = 1.00 m Art.-No.	€/ m	P = Unit
SPWSK 52 AE / 100	22.47	40
L = 2.50 m		
SPWSK 52 AE	21.70	40
L = 3.00 m		
SPWSK 52 AE / 300	21.70	40

Schlüter®-SHOWERPROFILE-WSC

semi-circular lip

L = 1.00 m Art.-No.	€/ m	P = Unit
SPWSC 16 GS / 100	9.55	40
L = 2.50 m		
SPWSC 16 GS	9.55	40
L = 3.00 m		
SPWSC 16 GS / 300	9.55	40

Schlüter®-SHOWERPROFILE-WSL

straight lip

L = 1.00 m Art.-No.	€/ m	P = Unit
SPWSL 30 T / 100	11.53	40
L = 2.50 m		
SPWSL 30 T	11.53	40
L = 3.00 m		
SPWSL 30 T / 300	11.53	40

Schlüter®-SHOWERPROFILE-WSK/EK

end cap

Art.-No.	€/ U.	P = Unit
EK / SPWSK 52 AE	3.02	50

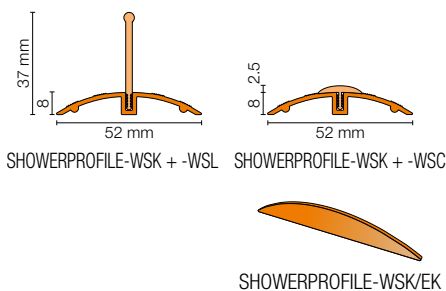

Schlüter®-DECO-SG

Schlüter®-DECO-SG is a decorative profile for joint design in tile coverings. It forms a 12 mm shadow joint, which is ideally suited for the insertion and attachment of glass elements in floor and wall areas.

(Product data sheet 2.16)

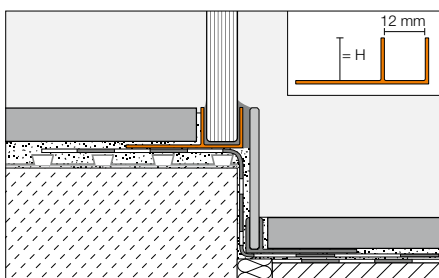

Schlüter®-DECO-SG-AE

anodised aluminium

H = mm	L = 2.50 m Art.-No.	€/ m	KV = Unit
8	SG 80 AE 12	13.78	120
10	SG 100 AE 12	14.15	120
11	SG 110 AE 12	14.48	120
12.5	SG 125 AE 12	14.85	120